

Inductive slot sensor

SJ15-E2-V1-Y23594

■ Comfort series



Dimensions

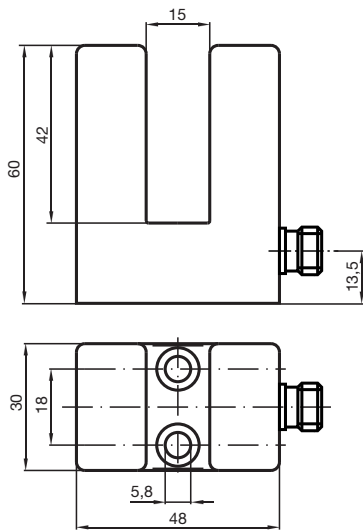

Technical Data

General specifications			
Switching function			Normally open (NO)
Output type			PNP
Slot width			15 mm
Depth of immersion (lateral)			17 ... 20 mm
Output polarity			DC
Output type			3-wire
Nominal ratings			
Operating voltage	U_B		10 ... 30 V
Switching frequency	f		0 ... 500 Hz
Reverse polarity protection			reverse polarity protected
Short-circuit protection			pulsing
Voltage drop	U_d		≤ 3 V
Operating current	I_L		0 ... 200 mA
No-load supply current	I_0		≤ 20 mA
Functional safety related parameters			
MTTF _d			1500 a
Mission Time (T _M)			20 a
Diagnostic Coverage (DC)			0 %
Compliance with standards and directives			
Standard conformity			

Release date: 2022-06-22 Date of issue: 2022-06-22 Filename: 023594_eng.pdf

Refer to "General Notes Relating to Pepperl+Fuchs Product Information".

Pepperl+Fuchs Group
www.pepperl-fuchs.com

USA: +1 330 486 0001
fa-info@us.pepperl-fuchs.com

Germany: +49 621 776 1111
fa-info@de.pepperl-fuchs.com

Singapore: +65 6779 9091
fa-info@sg.pepperl-fuchs.com

PEPPERL+FUCHS

Technical Data

Standards	EN 60947-5-2:2007 IEC 60947-5-2:2007
Approvals and certificates	
UL approval	cULus Listed, General Purpose
CSA approval	cCSAus Listed, General Purpose
Ambient conditions	
Ambient temperature	-25 ... 70 °C (-13 ... 158 °F)
Mechanical specifications	
Connection type	Connector plug M12 x 1 , 4-pin
Housing material	PBT
Degree of protection	IP67

Connection

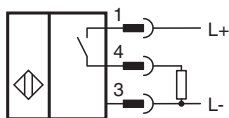

Connection Assignment

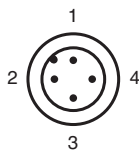

Wire colors in accordance with EN 60947-5-2

1	BN	(brown)
2	WH	(white)
3	BU	(blue)
4	BK	(black)